

DETAIL C - WINDOW SILL

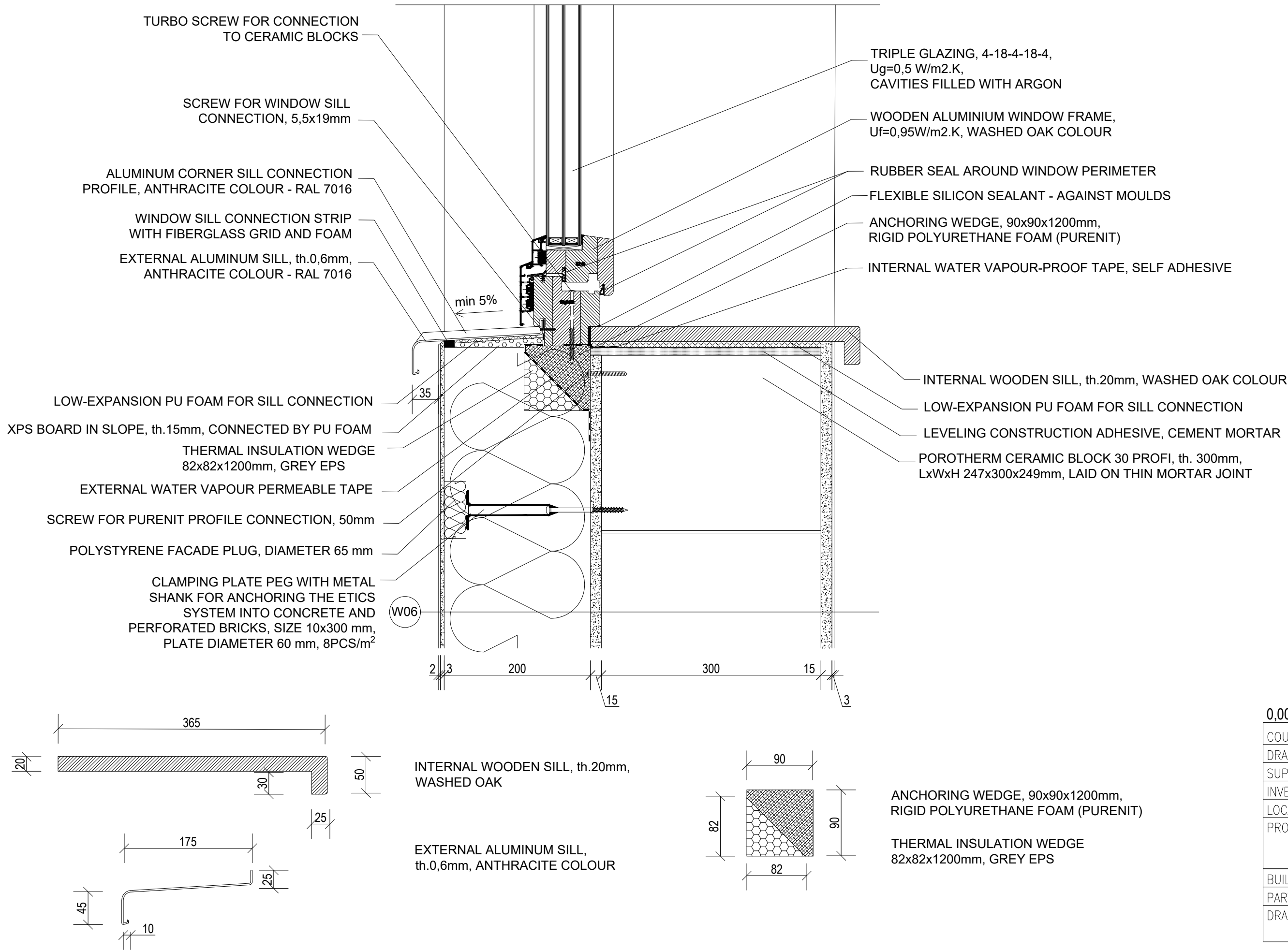

LEGEND OF MATERIALS:

- LOAD-BEARING WALL FROM CERAMIC BLOCKS POROTHERM 30 PROFI, th. 300mm, LxWxH 247x300x249mm, LAID ON THIN MORTAR JOINT, $R_w=48dB$, $REI\ 180\ DP1$
- FACADE THERMAL INSULATION FROM MINERAL WOOL, th.200mm, STRENGTH 30 kPa, $\lambda_d=0,034\ W/mK$
- WOOD
- PURENIT
- GREY EPS
- PLASTERS, ADHESIVE COMPOUNDS, DIFFERENT TYPES AND THICKNESSES, FOR EXACT SPECIFICATION SEE COMPOSITIONS
- LOW-EXPANSION PU FOAM
- TAPES

WALL COMPOSITION

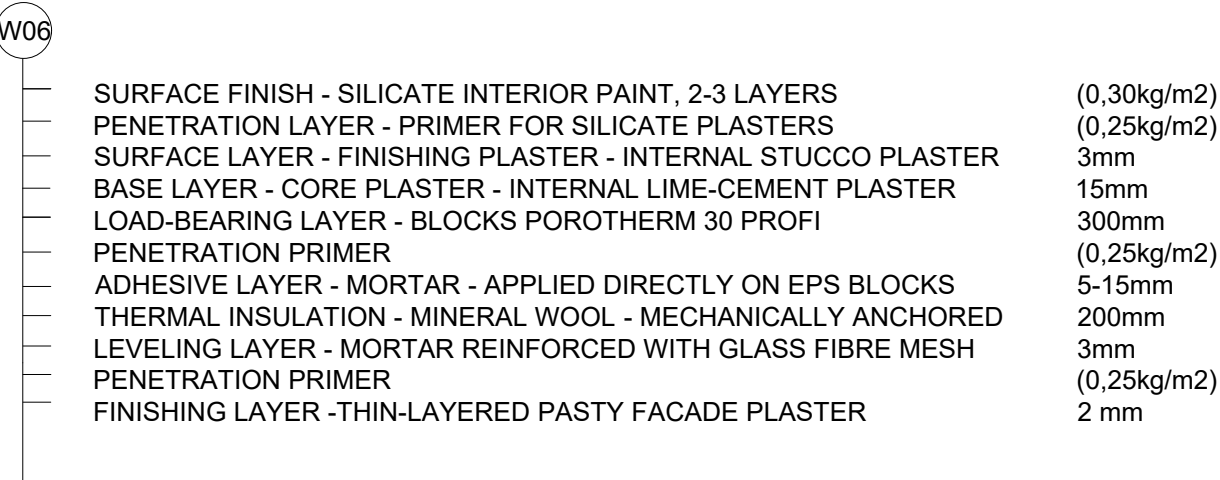

0,000 =240,24 m.a.s.l., B.H.S. / COORDINATE SYSTEM S-JTSK

COURSE	DIPLOMA THESIS	<div>FAKULTA STAVEBNÍ ústav pozemního stavitelství</div>	
DRAWN BY	BARBORA HUŠÁROVÁ		
SUPERVISED BY	ING. JAN MÜLLER PH.D.		
INVESTOR			
LOCATION	POŘADÍ, 687 51 NIVNICE, PARCELS No. 65, 64, 63, 61 ,57		
PROJECT TITLE	MUNICIPAL CENTRE IN NIVNICE	PAPER FORMAT	550x297
BUILDING OBJECT	BO 01 MUNICIPAL CENTRE	DATE	01/2025
PART	D.1.1 ARCHITECTURAL BUILDING SOLUTION	PROJ. PHASE	DPS
DRAWING TITLE:	DETAIL C - WINDOW SILL	SCALE	DRAWING NO.
		1:5	D.1.1.12